



**Eastwell Close, Sedgfield, TS21 3BL**  
**4 Bed - House - Detached**  
**£275,000**

**ROBINSONS**  
SALES • LETTINGS • AUCTIONS • SURVEYS



Nestled beautifully at the head of a small cul-de-sac; we are delighted to offer to the market with no onward chain, this deceptively spacious detached house with four bedrooms on Eastwell Close, within the heart of Sedgefield. This well proportioned residence has been a loving home for many years & whilst elements of the property do require some internal modernisation, it would be the perfect purchase for clients seeking a home which they can put their own stamp on. Having easy access to all of the immediate amenities the highly desirable village of Sedgefield has to offer & within excellent commuting distance to all major road links & bus routes, this impressive home also benefits from gas central heating via a combi boiler & double glazing. In brief, the property itself comprises: Welcoming entrance hallway with a beautiful vaulted ceiling, stairs to the first floor & access to a useful ground floor cloaks/wc, a spectacular lounge (measuring approximately 23ft) with window to front elevation & patio doors to rear, separate dining room & an impressive 18ft (approximately) kitchen with a range of fitted wall & base units with further access to garage. The first floor landing boasts four bedrooms & a re-fitted shower room. Externally, the property enjoys a low maintenance garden to the rear which is fully paved whilst to the front, there is a further paved area with access to the single garage. We encourage thorough internal inspection in order to fully appreciate the style, layout & potential of this beautifully positioned residence for sale.

FREEHOLD  
EPC Rating: D  
Council Tax Band: E

#### **ENTRANCE HALLWAY**

#### **GROUND FLOOR CLOAKS / WC**

**LOUNGE**  
23'4 x 11'6 (7.11m x 3.51m)

**DINING AREA**  
9'3 x 8'10 (2.82m x 2.69m)

**KITCHEN**  
18'8 x 7'9 (5.69m x 2.36m)

#### **FIRST FLOOR LANDING**

**MASTER BEDROOM**  
13'0 x 9'6 (3.96m x 2.90m)

**BEDROOM TWO**  
13'6 x 7'11 (4.11m x 2.41m)

**BEDROOM THREE**  
11'10 x 8'3 (3.61m x 2.51m)

**BEDROOM FOUR**  
8'3 x 7'11 (2.51m x 2.41m)

**SHOWER ROOM**  
7'0 x 6'3 (2.13m x 1.91m)

#### **EXTERNALLY**

#### **GARAGE**







# OUR SERVICES

Mortgage Advice

Conveyancing

Surveys and EPCs

Property Auctions

Lettings and Management

Strategic Marketing Plan

Dedicated Property Manager

## Eastwell Close, Sedgefield, TS21 3BL

Approximate Gross Internal Area  
1319 sq ft - 123 sq m

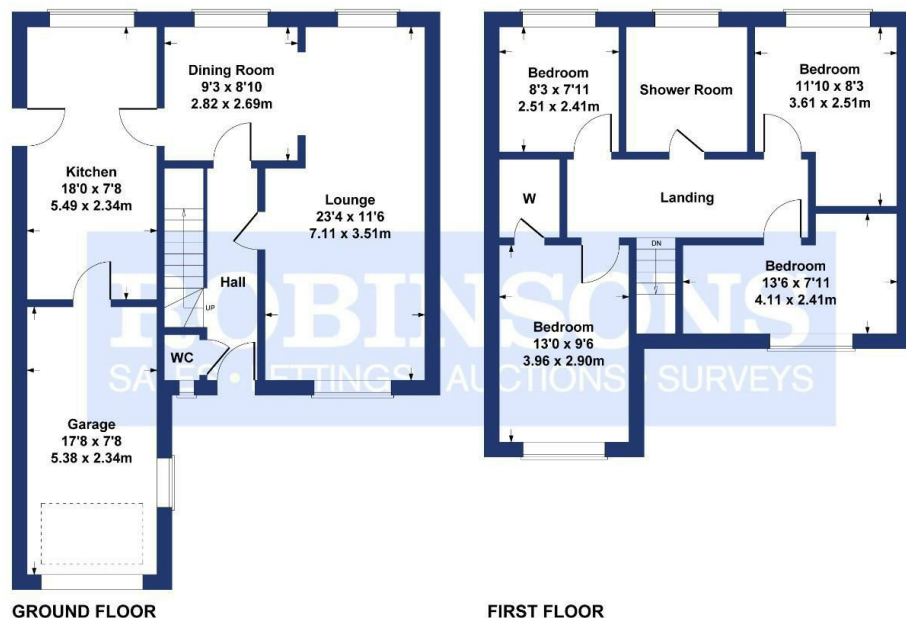

### SKETCH PLAN FOR ILLUSTRATIVE PURPOSES ONLY

All measurements walls, doors, windows, fittings and appliances, their sizes and locations, are approximate only. They cannot be regarded as being a representation by the seller, nor their agent.

Produced by Potterplans Ltd. 2025

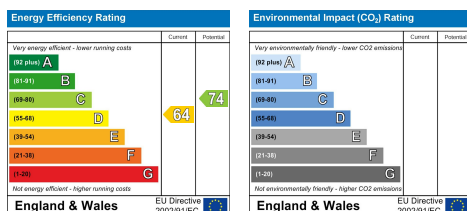

### DURHAM

1-3 Old Elvet  
DH1 3HL

T: 0191 386 2777 (Sales)

T: 0191 383 9994 (option1) (Lettings)

E: info@robinsonsdurham.co.uk

### DURHAM REGIONAL HEAD OFFICE

19A old Elvet  
DH1 3HL

T: 0191 383 0777

E: info@robinsonsdurham.co.uk

### CHESTER-LE-STREET

45 Front Street  
DH3 3BH

T: 0191 387 3000

E: info@robinsonscs.co.uk

### BISHOP AUCKLAND

120 Newgate Street  
DL14 7EH

T: 01388 458111

E: info@robinsonsbishop.co.uk

### CROOK

Royal Corner  
DL15 9UA

T: 01388 763477

E: info@robinsonscrook.co.uk

### SPENNYMOOR

11 Cheapside  
DH16 6QE

T: 01388 420444

E: info@robinsonsspenny Moor.co.uk

### SEDFIELD

3 High Street  
TS21 2AU

T: 01740 621777

E: info@robinsonssedgefield.co.uk

### WYNYARD

The Wynd  
TS22 5QQ

T: 0174 064 5444

E: info@wynyardfineandcountry.co.uk

Every care has been taken with the preparation of these particulars, but they are for general guidance only and complete accuracy cannot be guaranteed. If there is any point, which is of particular importance please ask or professional verification should be sought. All dimensions are approximate. The mention of fixtures, fittings &/or appliances does not imply they are in full efficient working order. Photographs are provided for general information and it cannot be inferred that any item shown is included in the sale. These particulars do not constitute a contract or part of a contract.

Robinsons can recommend financial services, surveying and conveyancing services to sellers and buyers. Robinsons staff may benefit from referral incentives relating to these services.



# ROBINSONS

SALES • LETTINGS • AUCTIONS

3 High Street, Sedgefield, TS21 2AU | Tel: 01740 621777 | info@robinsonssedgefield.co.uk

www.robinsonsestateagents.co.uk